

NIGHTFIGHTER KIT

FT-P48-NFKIT



KEY FEATURES:

- Direct drop-in NightFighter/Par 46 Replacement
- 2x Flood, 1x Spot Fixture
- Simple Installation with Basic Hand Tools

ABOUT THE NIGHTFIGHTER KIT

The Par 46 sealed beam fixture has been a staple in the fire service for years. Many fire apparatus were manufactured with a 12v 3x head "NightFighter" Halogen scene light. If you have this type of light on your rigs and are looking for an economical way to upgrade, the FT-P46-NFKIT has your name all over it. This kit includes 2 flood and 1 spot replacement modules that can be installed in your bays in under 20 mins. Just pop the old lamps out, swap the new LED modules in, connect the wires and you're good to go! Up to 10 times the light output while only drawing 120w. Need just a single replacement fixture? The single FT-P48 upgrade pops into any Par 46 fixture!

DIMENSIONS

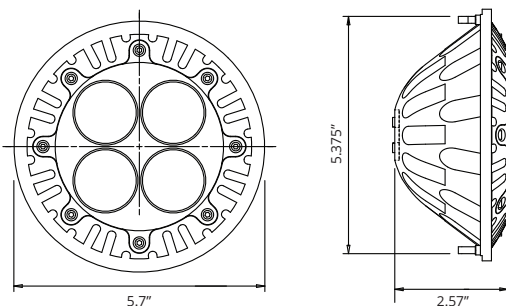

PART#: FT-P48-NFKIT

RAW LUMENS	10,800
EFFECTIVE LUMENS	6,480
OPT. BEAM PATTERNS	SPOT OR FLOOD
WATTAGE	120W
LEDs	12 X 10W LEDs



DIMENSIONS

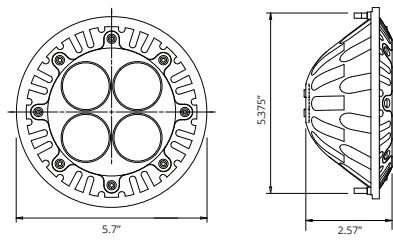

PART#: FT-P48	
RAW LUMENS	3,600
EFFECTIVE LUMENS	2,160
OPT. BEAM PATTERNS	SPOT OR FLOOD
WATTAGE	40W
LEDS	4 X 10W LEDS

Model / Order Number	Description	Raw Lumens	Effective Lumens	Wattage	Beam Pattern	Dimensions
FT-P48-NFKIT	NightFighter/Par 46 upgrade kit including 2 flood and 1 spot replacement modules. Silver housing.	10,800	6,480	120W	Spot, Flood	5.7" x 5.375" x 2.57"
FT-P48-F	Single Par 46 upgrade module. Flood. Silver housing.	3,600	2,160	40W	Flood	5.7" x 5.375" x 2.57"
FT-P48-S	Single Par 46 upgrade module. Spot. Silver housing.	3,600	2,160	40W	Spot	5.7" x 5.375" x 2.57"

